

# MR-35

product by Sicor

## SICOR's gear box series



Sicor machines meet the requirements of the following standards:  
95/16/CE- EN 292/1/2 - EN 294 - EN 12015:1999 - EN 12016:1999 - EN 60204-1 - EN 81-1 :1998

- Working process with CNC flexible machinery system. The components are tested with Zeiss three-dimensional testing machines.
- Final running-tests concerning vibrations, noise a.s.o. are carried out on 100% of gear boxes production.
- Smooth quite operation, noise level (within the range of VDI 2566) < 60 dBA are guaranteed by Sicor gearboxes.
- Cast iron EN-GJS-700-2-UNI EN 1563 with hardness over 250HB is used for traction sheaves.
- Twin-Brakes with mechanically independent action.
- Synthetic oil is used for each model.
- The standard motors used are of italian/foreign production, protection class F , insulation Class IP21 - AC1 and AC2 (180 St/H) with forced ventilation. ACVVVF (240 St/H), high efficiency CDF 60%.
- Standardized machine frames with/without deflection pulley, with vibration dampers are available.
- Off-standard constructions (extended shafts, drums, special machine frames, safety brakes on slow shaft) are available on demand.
- Gear boxes can be supplied equipped with Encoder, Tachometer and standard safety protections. Special protections are supplied on demand, according to customers drawings.
- Each gear box is complete with the "Operation and Maintenance Manual". The "Certificate of Conformity" is supplied on demand.
- The high quality of both the gear boxes projects criteria and the material used guarantee the long life of Sicor winches.



product by Sicor

# MR35 GEAR BOX

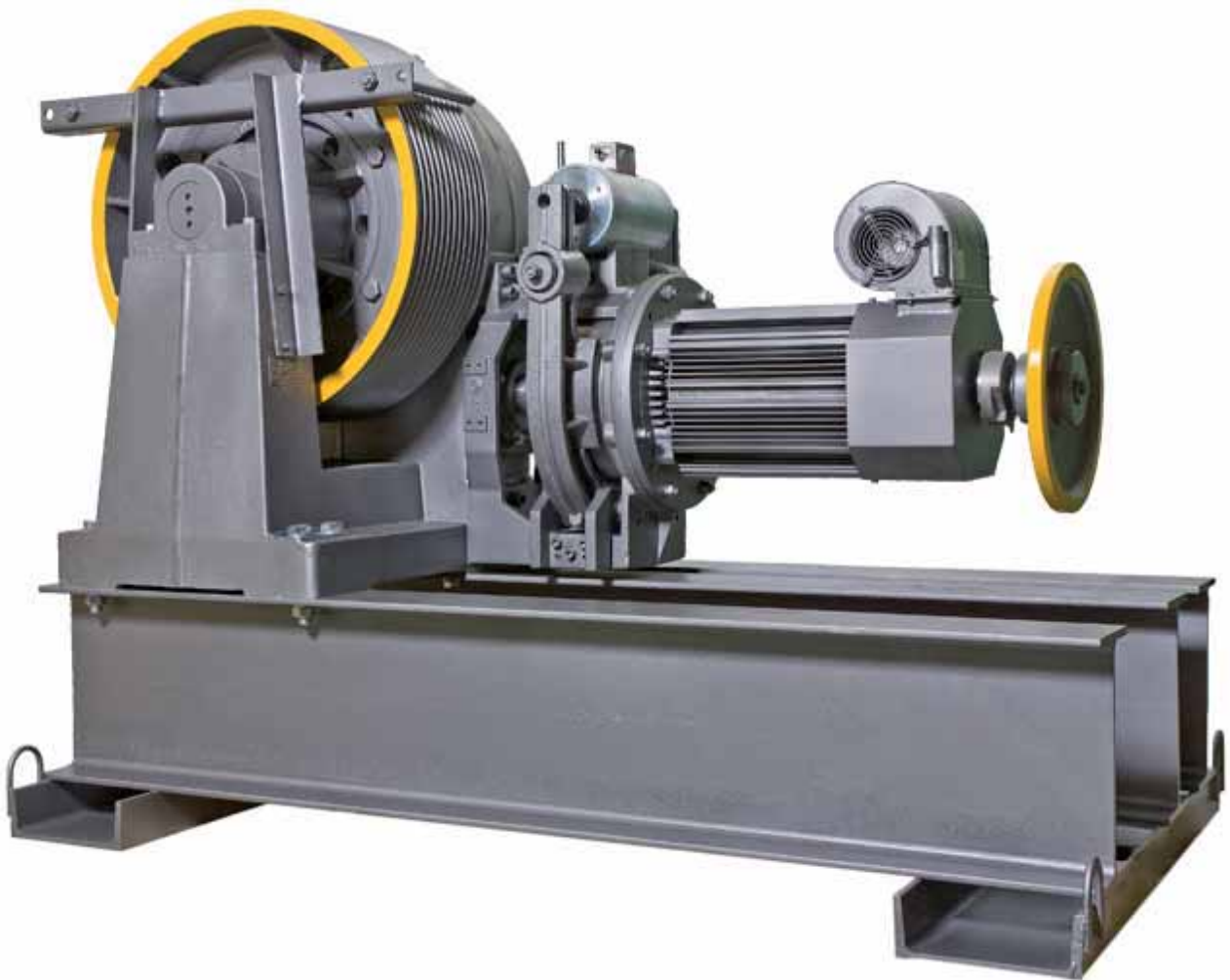

## FEATURES

Max static load: 14.200 kg  
 Range Power 50 Hz - 4/16 poles: 25 ÷ 43 kW  
 Range Power 50 Hz - 6/16 poles: 20 ÷ 36 kW  
 Range Power 50 Hz - 4 poles ACVVVF: 25 ÷ 43 kW  
 Range Power 50 Hz - 6 poles ACVVVF: 20 ÷ 36 kW  
 Ratio: 1/58 - 1/53 - 2/73 - 2/60 - 3/69 - 3/53  
 Gear weight: 1.600 ÷ 1.900 kg  
 Oil capacity: 23,5 lt

Roping System	TRACTION SHEAVE		Dimensions	Load	
	D (mm)	E (mm)	P (mm)	F (kN)	
CSW	770	252	275	140 <sup>1</sup>	
	885	208		70 <sup>2</sup>	

Electromagnet of Brake		
(V)	(A)	
60	6,12	
110	3,56	
200	1,80	

## DIMENSIONS

Max. static load on the slow shaft: \_\_\_\_\_  
 CSW Conventional Single Wrap F = 140 kN<sup>1</sup>  
 Horizontal component not to exceed F = 70 kN<sup>2</sup>  
 ESW Extended Single Wrap (patented)

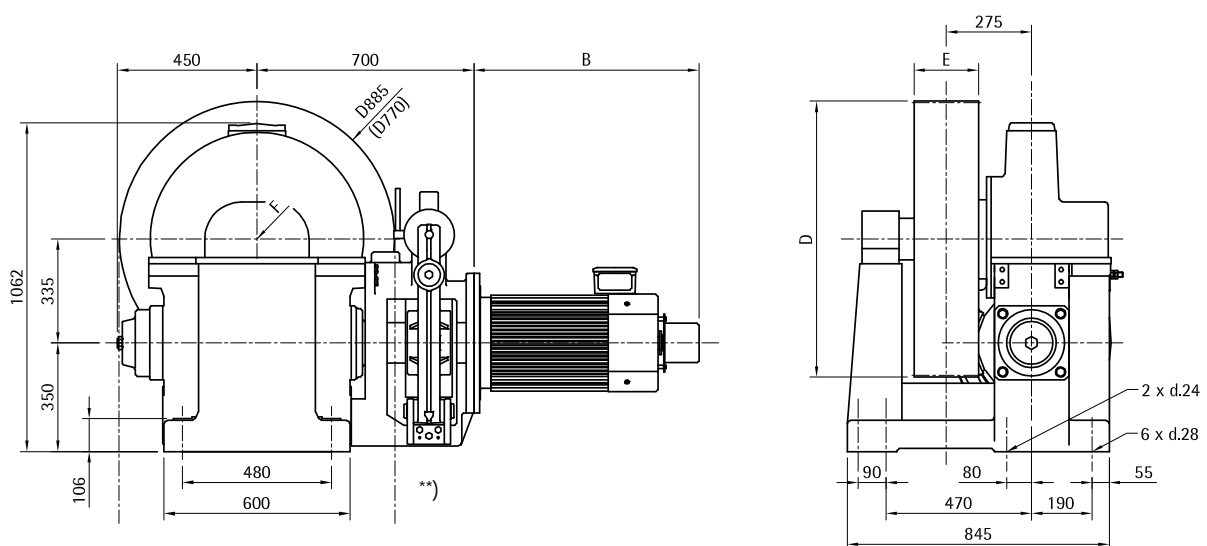









Company name: \_\_\_\_\_  
Address: \_\_\_\_\_  
Person referent: \_\_\_\_\_  
e-mail: \_\_\_\_\_

Date: \_\_\_\_\_  
Quantity: \_\_\_\_\_

## GEAR - GEARLESS

### GEAR DATA

GEAR TYPE	<input type="radio"/> GEAR <input type="radio"/> GEARLESS		
Installation position	<input type="radio"/> Righth-hand machine <input type="radio"/> Left-hand machine		
Gear ratio	.....		
Drive system	<input type="radio"/> AC1 <input type="radio"/> AC2 <input type="radio"/> ACVV <input type="radio"/> VVVF <input type="radio"/> DC		
Rpm and motor power	Rpm .....	Power (kW) .....	<input type="radio"/> Asynchronous <input type="radio"/> Synchronous
Motor Voltage and Frequency	V: ..... <input type="radio"/> 33 Hz <input type="radio"/> 50 Hz <input type="radio"/> 60 Hz		
Starting per hour	<input type="radio"/> 90 <input type="radio"/> 120 <input type="radio"/> 180 <input type="radio"/> 240		
Traction Sheave	Sheave Ø (mm) .....		
Ropes	N. Ropes .....	Ropes Ø (mm) .....	Pitch of grooves (mm) .....

### PLAN DATA

Roping	<input type="radio"/> 1:1 <input type="radio"/> 2:1		
Speed m/s	.....		
Gear position	<input type="radio"/> ABOVE MACHINE <input type="radio"/> BELOW MACHINE		
Travel and stops	Travel (m) .....	Stops n° .....	
Load	Useful load (Kg) .....	Cabin+car+frame+door operator (Kg) .....	CW (Kg) .....
Ropes	Weight (Kg) .....	Compensation <input type="radio"/> NO <input type="radio"/> YES	% ..... Kg. ....
Ropes distance (mm)	.....		

### SPECIAL SUPPORT

Type	<input type="radio"/> INTERNAL <input type="radio"/> EXTERNAL		
Extended shaft	Centre line gear - centre line sheave (mm) .....		

### MANUFACTURE

Made in ITALY			
Company name	<input type="radio"/> SICOR <input type="radio"/> Nuova MGT <input type="radio"/> SASSI		

**NOTE** .....

.....

.....

.....